

## PORTABLE INSTRUMENT AN601



### DESCRIPTION

AN601 is a digital portable instrument with a 5 digits red LEDs display, rugged, compact, with batteries, 6 push buttons, and one input channel with connector.

The device can be connected to strain gauge load cells, scales, dynamometers, pressure transducers, displacement transducers, liquid level measuring systems, temperature probes, inclinometers, accelerometers etc .

#### Main functions:

- Calibration with connected transducer allows to show, on display, measured values in engineering units (Kg, daN, °C, mm etc.).
- Sampling rate and filtering parameter setting
- Decimal point setting
- Zeroing with push button (of tare, preloads etc.)
- Positive or negative peaks value memorization

AN601 is rugged and easy to use and its typical applications are: quality control checking of sensors and transducers applied in production machineries by means of reference transducer, metrological controls, automation, force control of welding tools, medical machines, laboratory, dynamometer and scales checking etc.

## TECHNICAL CHARACTERISTICS

**Display:** 5 digits red LEDs display and high brightness allows reading it even with low ambient light

**Push buttons:** 6 pcs allow an easy calibration as well as use

**Input channels:**

- One single input channel, with IP65 connector and high stability and resolution (24 bit max A/D resolution)
- Input signals: 0 to  $\pm 80$  mV differential,  $\pm 5$  V,  $\pm 10$  V

**Batteries:** 4 pcs 1,5 V AA batteries that allow up to 16 hours of working (depending on current drawn from connected transducer), can be changed by means of lid (batteries and battery charger are not included)

**Power supply to connected transducer:** 5 Vdc filtered and stabilized

**Working temperature range:** -30 to +70°C, RH95%

**Weight:** 0,5 Kg.

**Sample range:** from 7.5 to 3840 Hz

## OVERALL DIMENSIONS

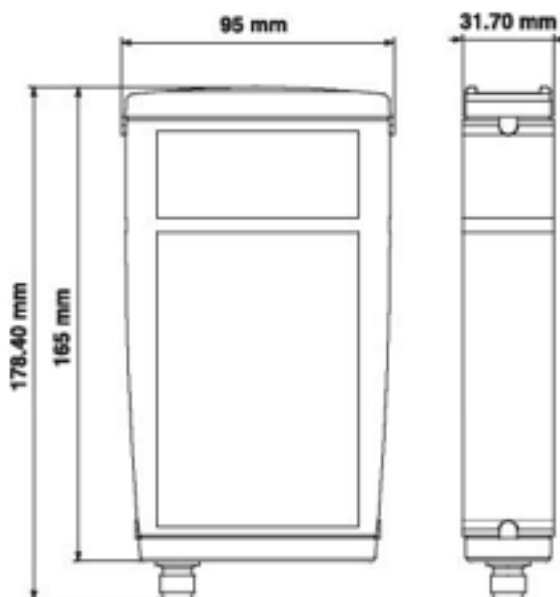

## DEVELOPMENT AND MANUFACTURING OF CUSTOM PRODUCTS

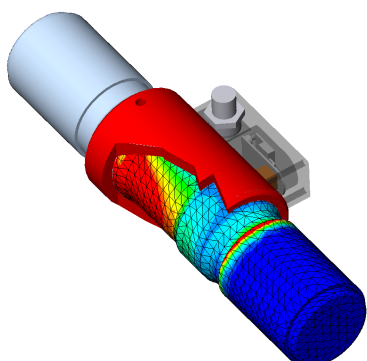

**S2Tech technical department**, with 30 years of experience acquired with DS Europe, can develop products according to customers technical specifications with the following tools:

- **3D** mechanical design CAD software stations
- **Finite Element Analysis** FEA software stations
- **Digital and analog electronic** development accordingly to EMC (=CE) stricter industrial marking regulations (with tests in anechoic room at Competent Body third part laboratory)
- **Software and embedded firmware** development according to most popular industrial bus systems (CANopen, Modbus, PROFIBUS etc.)
- Fast prototyping

S2Tech develops new products or modifies existing ones, in order to realize the fittest and more convenient product